

# TRACKTAP E

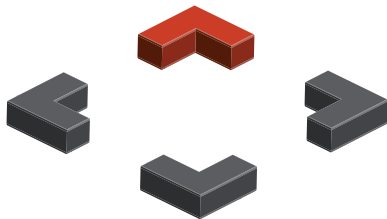

## TrackTape User Manual

TrackTape™ is a device for easy monitoring of outdoor sports performances. It works together with a web or smartphone application and a wireless charging plate is required to refill the battery.

### Charging TrackTape

Please use a quality wireless charging plate that is compliant with the Qi industry standard, together with a USB charger cable and a wall charger, capable of delivering at least 2A at 5V DC output. Please note that such charger is not part of the TrackTape

sales package. However, a selection of charger configurations with proven compatibility with TrackTape is listed at [www.tracktape.org](http://www.tracktape.org).

The actual time for a full charge will vary, depending on the charger deployed, but please expect 4h to accomplish a complete charging cycle. Typically the charging progress can be monitored by a LED on the charging plate but the indication varies for different chargers and the manual of the charging plate needs to be consulted for details. The battery state of charging is broadcasted according to the official standard for the Bluetooth Low Energy (BLE) battery service and can be monitored with any compatible application. Please refer to [www.tracktape.org](http://www.tracktape.org) for details and advice about such applications.

### Getting Started

TrackTape is completely motion-controlled and requires no specific interaction. For optimal performance, it should be attached to the wrist using the accompanying strap and oriented with the flat surface with the logo in upwards direction, towards the sky.

As you pick up TrackTape from the charging plate and begin a steady significant motion activity, it will start automatically and acquire a position. As soon as a valid location fix is acquired, a buzzer will sound and the device will start reporting its position to the preconfigured monitoring application. When significant user motion is no longer detected, TrackTape will go into power saving mode and stop reporting its position.

Please pay attention to that TrackTape is an outdoors location device and clear sight to the sky is required. Any covering layer of humid textile should be avoided in order not to jeopardize the location performance. The position sample and upload intervals will follow the configuration settings in the embedded software or be configurable from the target monitoring application.

### Technical Specifications

**Primary radio interface:** Quad-band GSM/GPRS modem (850/900/1800/1900MHz, 3GPP rel. 4) with output power class 4 (2W) @ 850/900MHz and class 2 (1W) @ 1800/1900MHz, respectively.

**Secondary radio interface:** Bluetooth Low Energy, V5.

**Location technique:** GPS/Glonass/  
QZSS multi-constellation receiver.

**Sensors:** always-on motion sensing.

**User interface:** buzzer.

**Battery:** lithium polymer.

**Charging:** Qi standard (WPC V1.1).

**Dimensions:** 52mm x 39mm x 15mm.

**Weight:** 30g.

**Enclosure material:** ABS.

**Operating temperature range:** min:  
-10°C, nom: 20°C, max: 60°C.

**Charging temperature range:** min:  
0°C, nom: 20°C, max: 30°C.

### **Caution**

**Do not** try to open or dismantle the device. Should the device, for some reason, anyway, be found in opened

state – do not attempt to replace the battery.

**Do not** expose the device or its battery to mechanical bending, crushing or cutting, as this may cause an explosion.

**Do not** expose the device to extreme temperatures above or below the operating temperature range, as this may cause an explosion or the leakage of flammable liquid or gas.

**Do not** expose the device to extremely low air pressure, as this may cause an explosion or the leakage of flammable liquid or gas.

### **Legal information**

This user manual is published by TrackTape AB without any warranty and maintained at [www.tracktape.org](http://www.tracktape.org). Changes to this user guide may be made by TrackTape AB at any time and without notice. All rights reserved © 2020 TrackTape AB.

**We, TrackTape AB**, declare under our sole responsibility that our product, **TrackTape G**, is conformant to the following standards: IEC 62133, Draft EN 301 489-1 V2.2.0 + Draft EN 301 489-17 V3.2.0 + EN 301 489-19 V2.1.1 + Draft EN 301 489-52 V1.1.0, EN 301 511 V12.5.1, EN 303 413 V1.1.1, EN 300 328 V2.1.1 (1Mbps), EN 62368-1:2014 + AC:2015 as well as RoHS Directives 2011/65/UE, 2014/1/UE to 2014/6/UE and 2014/8/UE to 2014/16/UE.

As regards the following regulations related to specific absorption rate (SAR): EN 50566 (2017), IEC62209-2 (2010) and EN 62209-2 (2010), TrackTape G has been tested and found to comply with the requirements in respect of all parameters subject to the test.

Löddeköpinge 2020-02-17



**Carl Fredrik Leanderson,**  
Founder

### **Contact information**

[www.tracktape.org](http://www.tracktape.org)

TrackTape AB, Teknikvägen 19F,  
246 43 Löddeköpinge, Sweden